



SOLAR PANEL

DFE100S-12U

High Efficiency Monocrystalline PV Module

33 CELL

MONOCRYSTALLINE MODULE

100W

POWER OUTPUT

20.00%

MODULE EFFICIENCY

5%

POSITIVE TOLERANCE

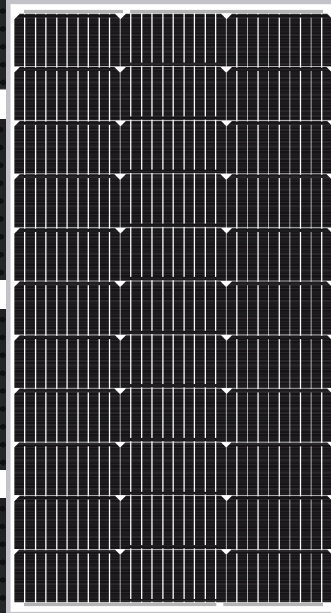

- Nominal 12V DC for standard output.
- Outstanding low-light performance.
- Heavy-duty anodized frames.
- High transparent low-iron, tempered glass.
- Designed to withstand high wind pressures, Hail, and heavy snow.
- Quality aesthetic appearance.



High Efficiency

Module Efficiency improved through advanced cell technology and manufacturing capabilities.



High PID Resistance

Advanced cell technology and qualified materials lead to high resistance to PID.



Withstand Harsh Environment

High PID Resistance

5400 Pa positive load
2400 Pa negative load
Salt mist (IEC 61701)

Performance Warranty

10 years
Product Warranty

25 years
Power Warranty

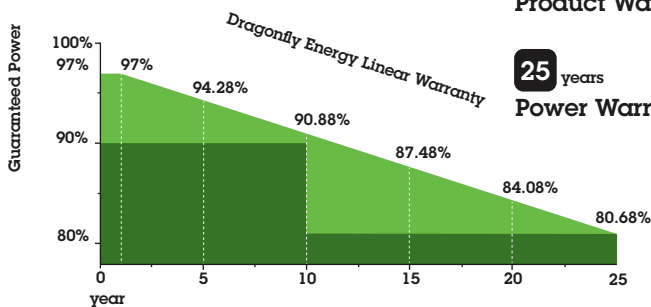

Product Certificate

IEC 61215, IEC61730

Management Certificate

ISO 9001:2016

Other certificate

Fire Rating Class C, TÜV Rheinland

Positive mechanical load

>5400Pa

Positive power tolerance

0~+5W

Warranty information

2 Year Product Warranty and Workmanship

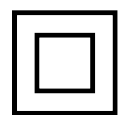

www.dragonflyenergy.com



solar@dragonflyenergy.com



(855) 292-2831 Ext. 027

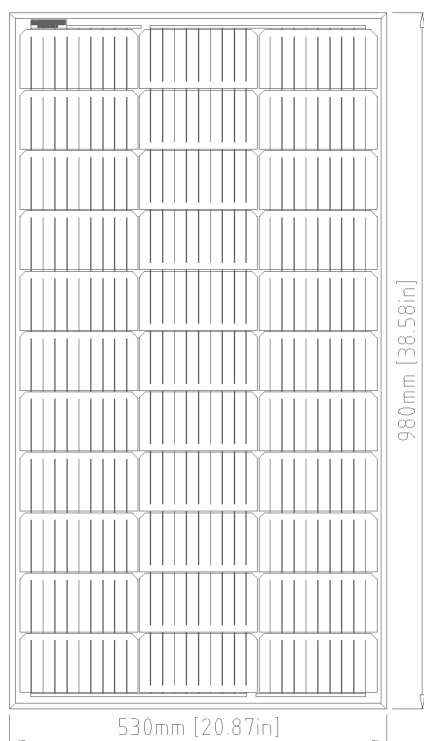

Electrical Characteristics	DFE100S-12U
Product Code	100031201A
Maximum Power (P _{max})	100W
Voltage at P _{max} (V _{mp})	19.23V
Current at P _{max} (V _{mp})	5.21A
Open-circuit Voltage (V _{oc})	22.12A
Short Circuit Voltage (V _{oc})	5.50A
Temperature Coefficient of V _{oc}	-(80±10)mV/°C
Temperature Coefficient of I _{sc}	(0.065±0.015)%/°C
Temperature Coefficient of Power	-(0.5±0.05)%/°C
NOCT (Air 20°C; Sun 0.8kW/m ² wind 1m/s)	47±2°C
Operating Temperature	-40°C to 85°C
Maximum System Voltage	1000V DC
Power Tolerance	±5%

*STC: Irradiance 1000/m², AM1.5 spectrum, module temperature 25°C

*NOCT: Nominal operating cell temperature (the data is only for reference)

Specifications	DFE100S-12U
Cells	Monocrystalline silicon solar cell
No. of cells and connections	33(3x11)
Module dimension	980mm[38.58in.]x530mm[20.87in.]x30mm[1.18in.]
Weight	6.49kg[14.32lbs]
Packing information	1030mm[40.55in.]x580mm[22.83in.]x80mm[3.15in.]/(1pc/ctn)

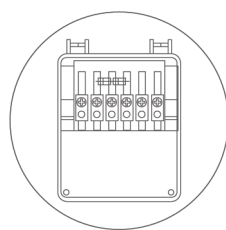

Junction Box
Top View (Lid Open)

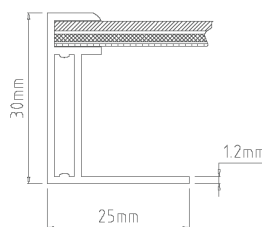

Section A-A

Characteristics

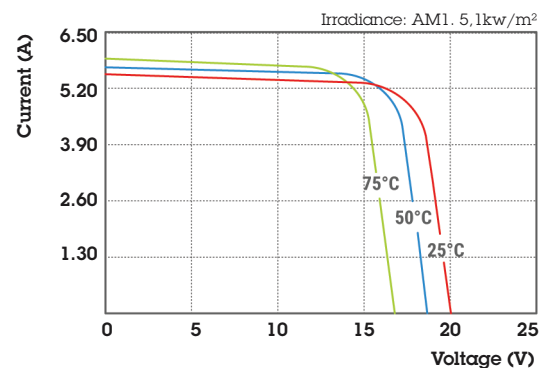

DFE100S-12U I-V Curves

Dimensions in brackets are in inches.
Un-bracketed dimensions are in millimeters.
Unit: mm[in.]