



# Model BBGC3

270AH 12V

LiFePO<sub>4</sub> Deep Cycle Battery

**Data sheet**

## Electrical Specification

Voltage	12V
Capacity	270AH
Operating Temperature	-4°F (-20°C) to 135°F (57.2°C)
Efficiency	99%
Self Discharge	2-3% per month
Maximum Series Voltage	48V
Cycles	3K-5K
Built-in BMS	Internal
Resistance	5 mΩ
Usable DoD	100%

## Discharging Specification

Max Discharge Current	300A
Peak Discharge Current	500A for 30 Seconds
Surge for Loads over 500A	.5 Seconds
Recommended LVD	10.5V
BMS Discharge Voltage Cut-Off	10V
Reconnect Voltage	10V
Short Circuit Protection	Yes

## Recognized Specification

Certifications	Pending
Shipping Class	UN3480, Class 9

## Drawing Specification

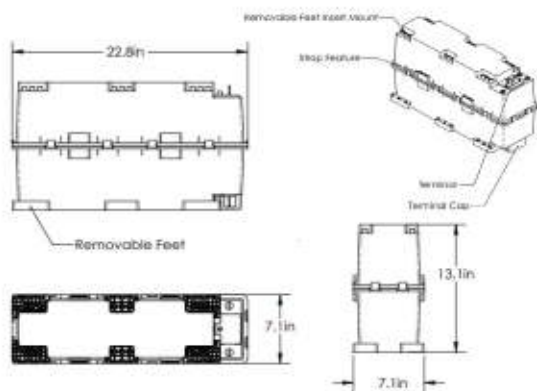

## Charging Specification

Recommended Charge Current	.5c
Max Charge Current	135A
Absorption Voltage	14.2V-14.6V
Float Voltage	13.4V-13.8V
Equalization Voltage (if applicable)	14.4V
Absorption Time	100 Minutes per 270AH battery bank
BMS Charge Current Cut-Off	.5C Recommended
Recharge/Rebulk Voltage	13.3V
BMS Cell Balancing Voltage Range	14.2V-14.6V
High BMS Voltage Protection	14.7VDC
Temperature Compensation	No/Disable

## Mechanical Specification

Dimensions	22.83"L X 7.09"W X 13.15"H
Weight	80.8 lbs.
Terminal Type	.25" Brass
Terminal Hole	3/8" hole and 3/8" or 5/16" hardware is suggested
Terminal Torque	9-11 Ft-lb.
Case Material	ABS Fire Rated
Cell Type - Electrolyte	LiFePO <sub>4</sub>
Sealed and Water Resistant Case	Non-Submersible

## Temperature Specification

Discharge Temperature	-4°F to 135°F (-20°C to 57.2°C)
Charge Temperature	25°F - 135°F
Storage Temperature	-10°F to 140°F (-23°C to 60°C)
BMS High Temperature Cut-Off	>135°F
BMS Reconnect Temperature	<135°F



# Model BBGC3

270AH 12V  
LiFePO<sub>4</sub> Deep Cycle Battery  
Data sheet

## Performed Operation Data

### .5C Discharge with Temperature Variations

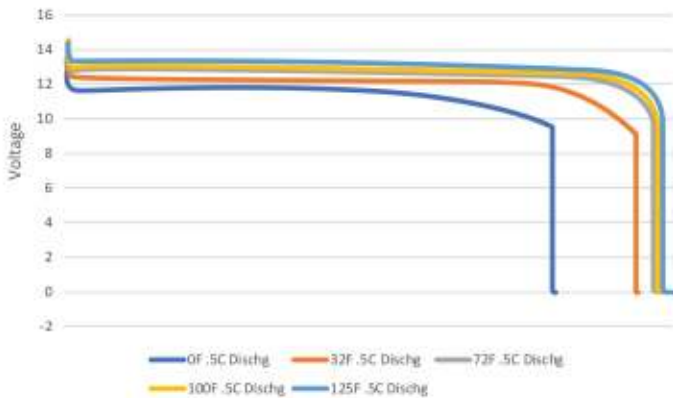

### 1C Discharge Voltage with Temperature Variations

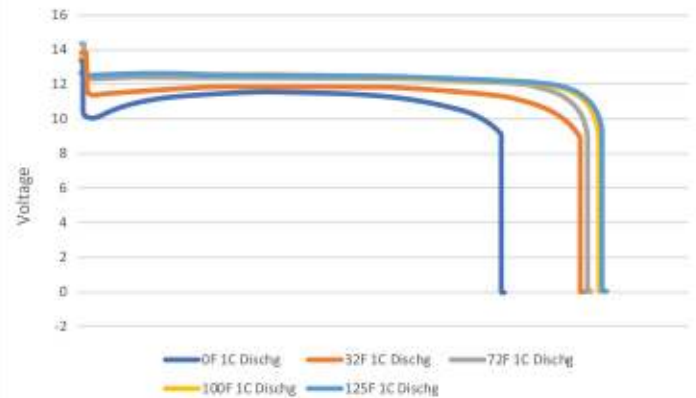

### .5C State of Charge with Temperature Variations

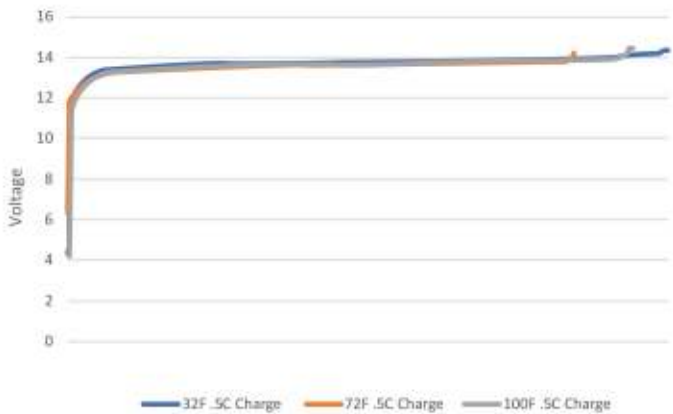

### Standard Charge Curve with 3 Stage Charger

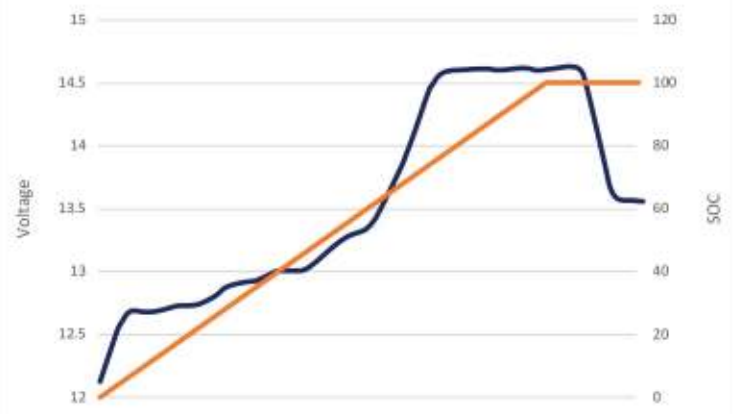

\*Note: The storage temperature range is -10°F to 140°F (-23°C to 60°C). We recommend bringing the Battle Born Batteries to a 100% charge and then disconnecting them completely for storage. After six months in storage, your batteries will remain 75 – 80% charged.

Storing batteries in subzero weather (-15°F or more) has the potential to crack the ABS plastic and more importantly could cause a faster loss of capacity, in some cases drastically more than the typical 2 – 4% per month loss.